

**Plant Schedule**

**Trees & shrubs - whips; one plant sq. m. Total: 3675 sq. m.**

Latin Name	Common Name	% mix	size (height)	specification	number
<i>Acer campestre</i>	Field Maple	10%	40-60cm	BR; min 3 brks	365
<i>Alnus glutinosa</i>	Alder	5%	40-60cm	BR; min 3 brks	185
<i>Betula pendula</i>	Silver Birch	10%	40-60cm	BR; min 3 brks	365
<i>Corylus avellana</i>	Hazel	15%	40-60cm	BR; min 3 brks	555
<i>Crataegus monogyna</i>	Hawthorn	5%	40-60cm	BR; min 3 brks	185
<i>Fagus sylvatica</i>	Beech	5%	40-60cm	BR; min 3 brks	185
<i>Ilex aquifolium</i>	Holly	5%	3lt CG	min 5 brks	185
<i>Quercus robusta</i>	Common Oak	10%	40-60cm	BR; min 3 brks	365
<i>Rosa arvensis</i>	Field Rose	15%	3lt CG	30-45cm height	555
<i>Sambuccus nigra</i>	Elder	10%	40-60cm	BR; min 3 brks	365
<i>Sorbus aucuparia</i>	Rowan	10%	40-60cm	BR; min 3 brks	365
<b>Totals</b>		<b>100%</b>			<b>3675</b>

**Woodland seed mixture - EW1**  
26125m2 From Emorsgate Seed (01553 829028) or similar approved

**Key for Tree Retention/Removal**

- Retained tree/group of trees. Root Protection Area in blue. Text indicates tree/group number on corresponding tree survey
- Canopy extents of Category A trees
- Canopy extents of Category B trees
- Canopy extents of Category C trees
- Trees/group of trees proposed for removal Root Protection Areas shown with canopy extents in bold. Text indicates tree/group number on corresponding tree survey

**Key**

- Lodge 9.75m x 3.60m
- Lodge 13.10m x 4.23m

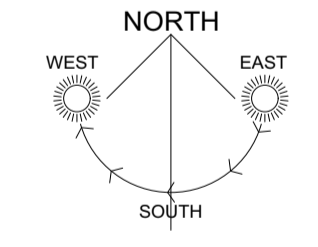
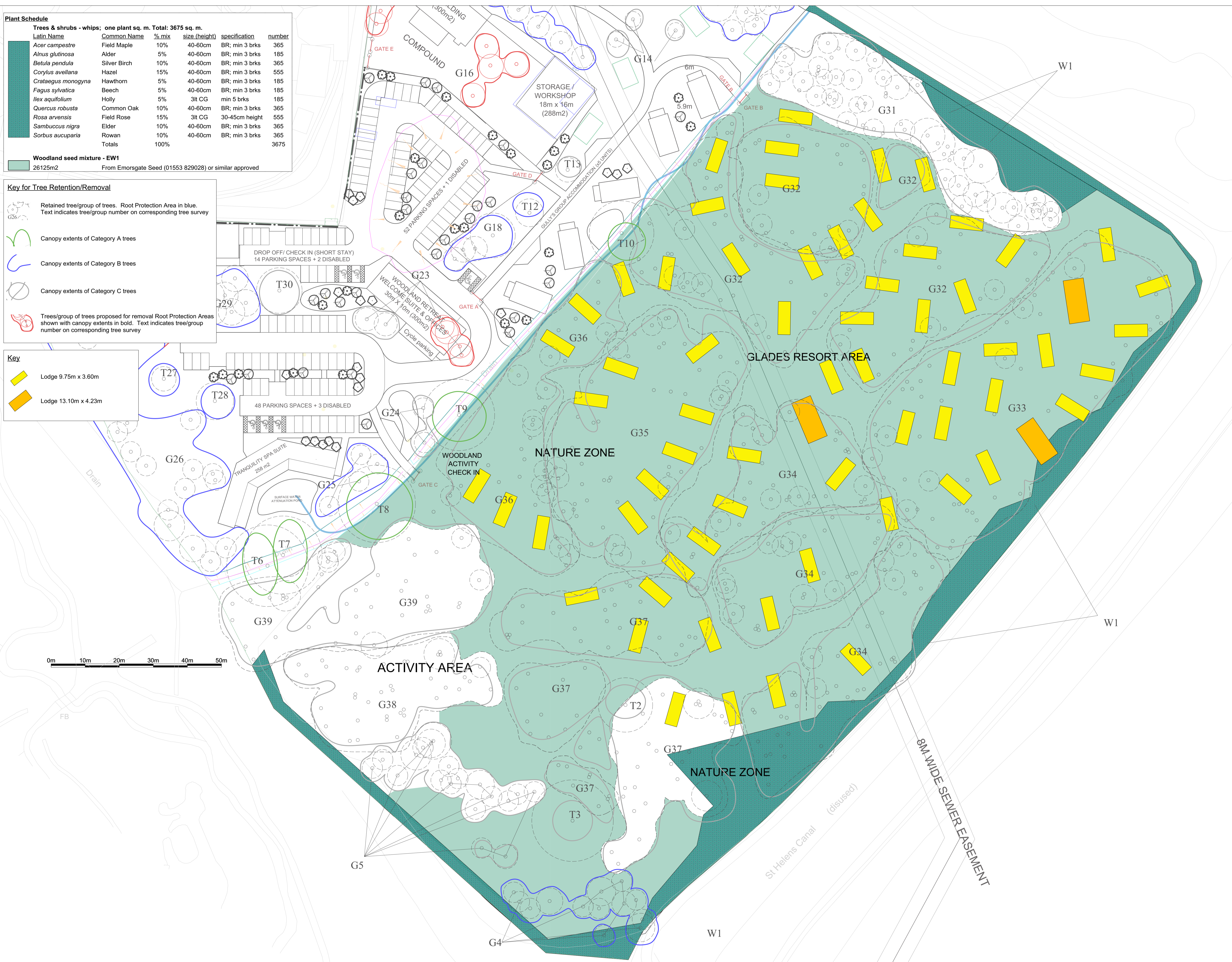

Rev	Details	Date	Drawn

**General notes:**

- Do not scale from this drawing
- All dimensions are in metres unless noted otherwise.
- All dimensions shall be verified on site before proceeding with the work.
- Environmental Associates shall be notified in writing of any discrepancies.
- All dimensions are nominal dimensions.
- Environmental Associates accept no liability for any expense loss or damage of whatever nature and however arising from any variation made to this drawing or in the execution of the work to which has not been referred to them and prior approval obtained.
- This drawing is for planning purposes only

**environmental associates**  
landscape architects • urban designers • environmental planners

Client: Gulliver's World  
Project: Shackleton Close, Old Hall, Warrington WA5 9YZ  
Project: Gulliver's World Woodland Retreat

Title: **Woodland Development - Layout and Planting**

Project No: EA-5410	Drawing No: 002	Revision:
Scale: 1:500 @ A1	Date: 18/02/2020	

Chapel House, City Road, Chester, CH1 3AE, UK  
Tel: 01244 311666  
email: ea@environmentalassociates.net  
web: www.environmentalassociates.net

© This drawing is subject to copyright